

ous . property



16 Pilla Avenue New Port SA

3  2  2 

Available Now

Sensational design and quality, sleek and sophisticated, this waterfront home overlooking the Marina offers the ultimate life-style.

Building Size : 265 sqm

View : <https://www.ous.property/lease/sa/western-beachside-suburbs/new-port/residential/townhouse/6201788>

Beautiful open plan living at ground level comprising:

- Spacious dining and lounge with gas fire
- Stylish white 2-pac kitchen with island bench, stainless steel appliances, 900mm oven and 5 burner cooktop all complimented by glass splashbacks and ceaser stone benchtops
- Highly polished floating timber floor
- Powder room
- Under stair storage
- Paved courtyards front and rear offer versatile entertaining with sliding doors to the internal living space,

<https://www.ous.property>

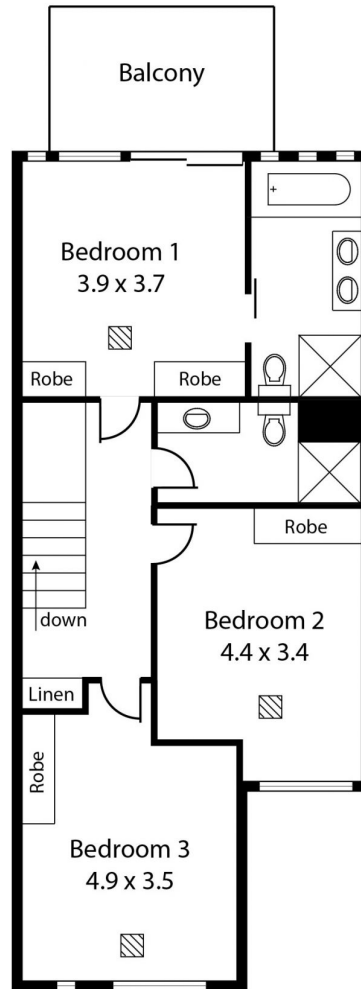
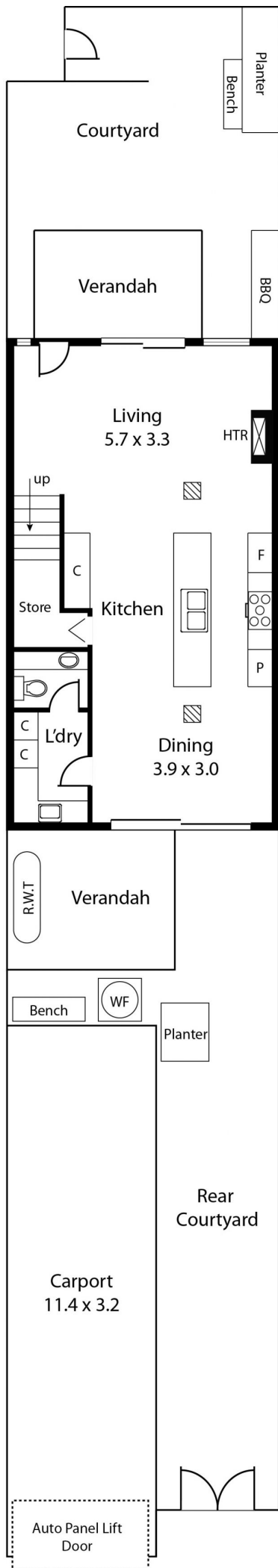

Living:	128.33 sqm
Courtyard/s:	71.83 sqm
Carport:	37.09 sqm
Verandah/s:	19.42 sqm
Balcony:	08.97 sqm
Total:	265.64 sqm