

# ous . property

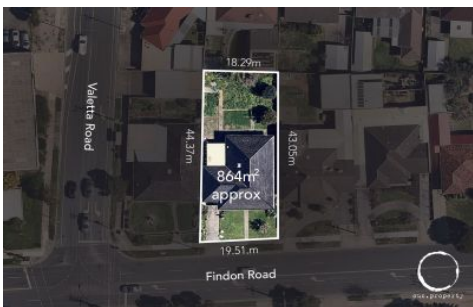

## 400 Findon Road Kidman Park SA

3 2 2

This three bedroom brick home built in 1985 presents appealing opportunities. Set on a substantial 864m<sup>2</sup> block (approx.) with 19.51m street frontage, it is an ideal development site (STCC). But with a very generous floorplan comprising large bedrooms, two bathrooms and both formal and casual living spaces, it also makes a fantastic family home.

The immaculate décor is classic 1980's in excellent original condition, offering the potential to live comfortably for now and update at your leisure.

The location is also perfect for families, with an abundance of schools to choose from and the Lockleys childcare centre and ELC nearby. Coupled with its proximity to nature reserves including the Linear Park River Torrens trail and Valetta Reserve, along with accessible shops and

**Price** : \$ 530,000  
**Land Size** : 864 sqm  
**View** : <https://www.ous.property/sale/sa/western-beachside-suburbs/kidman-park/residential/house/6202002>



**Laz Ouslinis**  
**7225 9800**

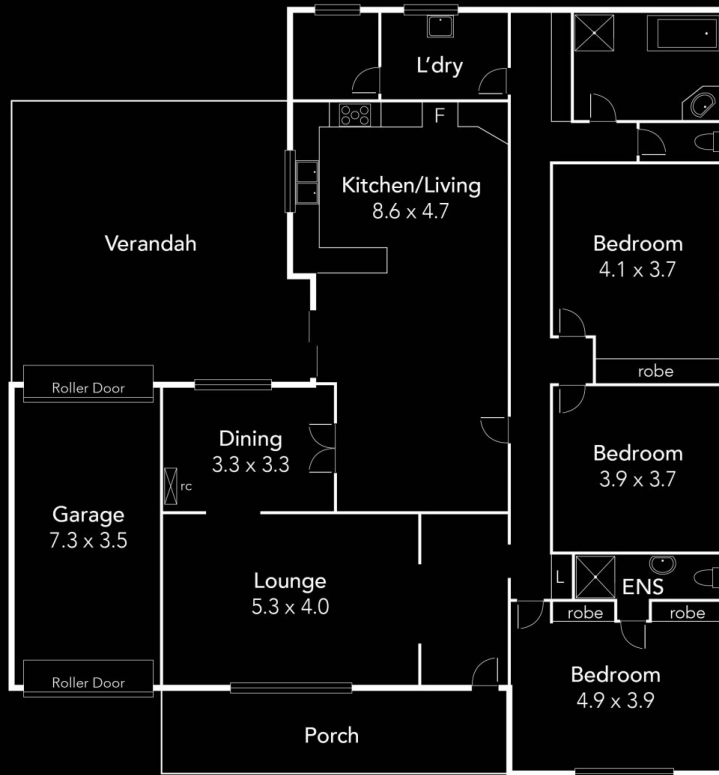

\* To check measurements...  
  
 Please ask your agent  
 for a tape measure

\*This drawing is for illustration purposes only. All measurements are approximate and details intended to be relied upon should be independently verified.