

ous . property



28 Strathmore Avenue Lockleys SA

4  2  2 

****CONTACT AGENT FOR A PRIVATE INSPECTION****

****Please refer to last image re: ous.property policies & procedures amidst COVID-19****

Bursting with architectural flair & luxury finishes, this executive home on 649m2 (approx.) features four double bedrooms & extraordinary living spaces with seamless indoor/outdoor flow.

Built in 2010 by Alan Sheppard Constructions, this entertainer will wow your guests with dazzling design elements & supreme craftsmanship.

Behind the scenes you'll find smart design creating natural airflow in summer & inviting the warmth of winter sunshine. Double glazing & 4.2kw solar panels add to the economy of the home while stunning gas fireplaces create the sort of

Price : \$ 1,710,000

Land Size : 649 sqm

View : <https://www.ous.property/sale/sa/western-beachside-suburbs/lockleys/residential/house/6202175>



Laz Ouslinis
7225 9800

<https://www.ous.property>



Ground

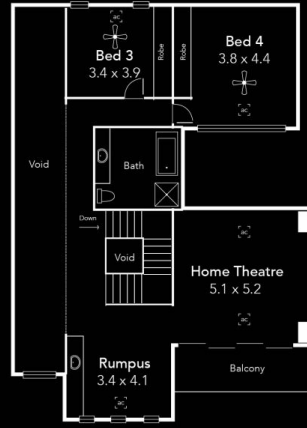

Upper

* To check measurements...



Please ask your agent for a tape measure