

ous . property



13 Wentworth Street Lockleys SA

3 1 1

When your neighbourhood includes the River Torrens Linear Park trail, a championship golf course and a fabulous local reserve boasting a playground and multiple sporting clubs, family life is looking rosy!

Located a pleasant stroll from all these perks is a classic 1960's ranch-style, double brick all-rounder. Flaunting big bedrooms and a spacious L-shaped living and dining room typical of the era, this updated family home warmly welcomes you to the liveable and loveable Lockleys lifestyle.

The 702sqm block (approx.) with 22m frontage features a secure carport and off-street parking. The generous floorplan incorporates an inviting outdoor entertainment area, three big bedrooms, open plan living plus a sparkling new kitchen, bathroom and laundry.

Land Size : 702 sqm
View : <https://www.ous.property/sale/sa/western-beachside-suburbs/lockleys/residential/house/6917468>



Nick Tuck
7225 9800



Matt Plumridge
7225 9800

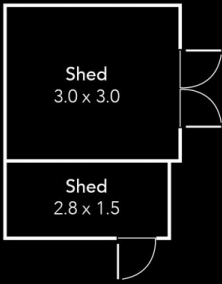

Area (Estimate only)	
Living	108.7 m ²
Carport	22.3 m ²
Pergola	35.2 m ²
Shed	14.7 m ²
Total	180.9 m ²

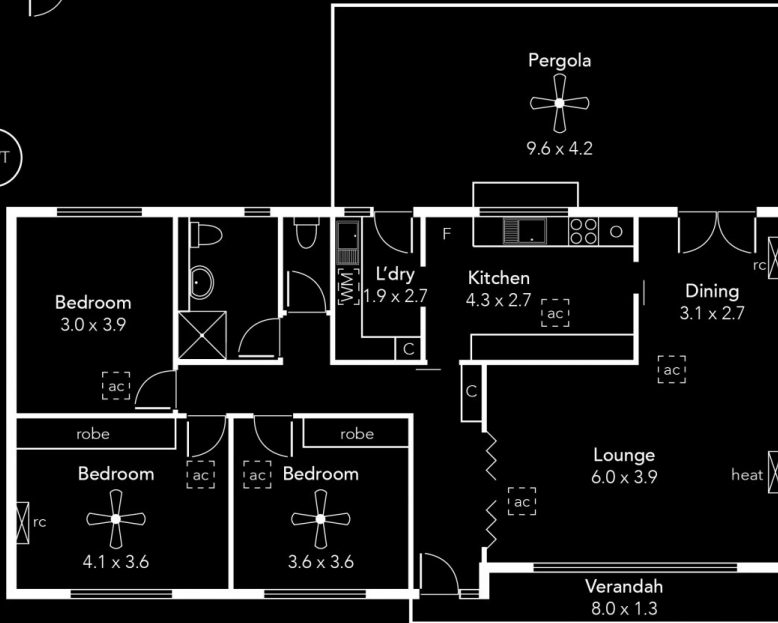

*To check measurements



Please ask your agent
for a tape measure



Carport
4.2 x 6.2

