



18 Railway Terrace Mile End SA

3 1 2

Perched right on the city fringe in a western burbs locale enriched with cosmopolitan character, this c.1910 stone villa beckons buyers handy with a paintbrush and a toolbox or two.

On a valuable 708sqm block (approx.) this heritage listed home presides with a rightful air of entitlement about its imposing three bedroom, two living room floorplan featuring front and rear verandahs.

The romantic facade makes way for a grand entry hallway leading to majestic rooms with sky high ceilings and commanding proportions. Fireplaces, chandeliers and distinguished original woodwork speak of enchanting bygone eras with whispers of promising prospects for lucky new owners.

Price : \$ 1,115,000
Land Size : 708 sqm
View : <https://www.ous.property/sale/sa/western-burbs/eachside-suburbs/mile-end/residential/house/7037815>



Phil Tropeano
7225 9800



Laz Ouslinis
7225 9800

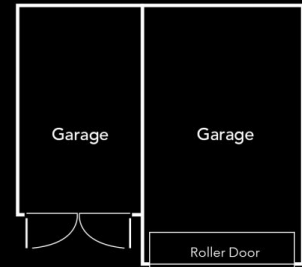
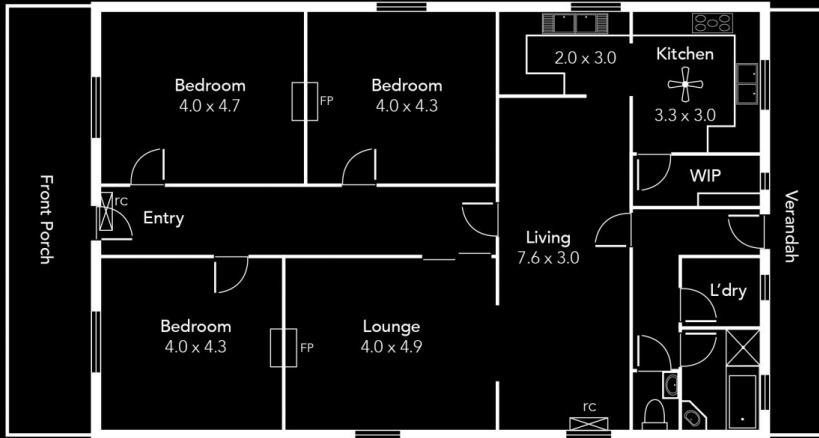

Area (Estimate only)	
Living	149.0 m ²
Porch	18.7 m ²
Verandah	12.8 m ²
Total	180.5 m²

*To check measurements



Please ask your agent for a tape measure