

ous . property

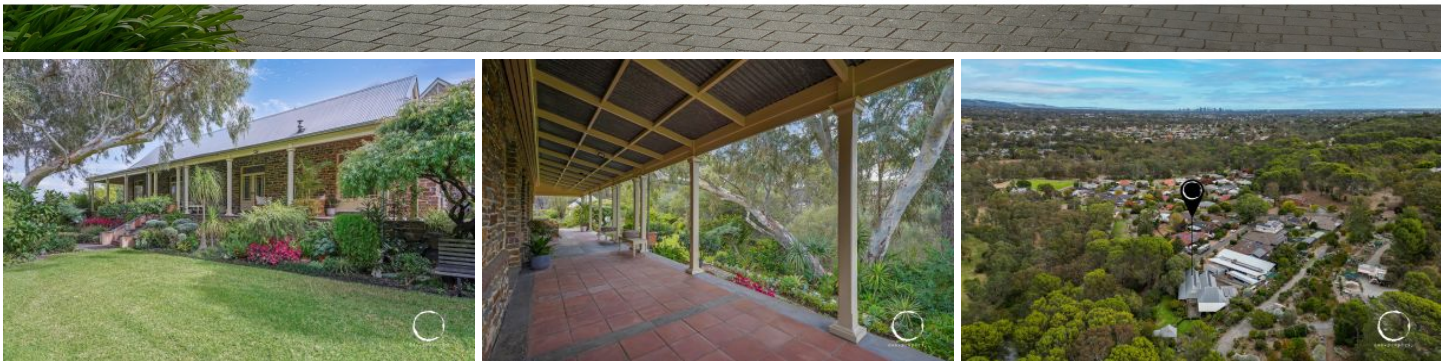

EXCLUSIVE OFF MARKET



12 Pioneer Court Highbury SA

3 2 3

Nestled directly alongside the scenic Linear Park, this remarkable residence on a staggering 1405sqm (approx.) allotment offers an unparalleled lifestyle defined by picturesque walking trails and abundant local birdlife. Situated at the tranquil end of a secluded cul-de-sac amongst other quality homes, this sprawling homestead-style abode is tailor-made for grand entertaining.

Boasting expansive rooms and lofty 3-meter ceilings throughout, the home exudes a sense of spaciousness and grandeur. The thoughtfully designed floorplan ensures privacy, with the bedrooms tucked away from the main living areas.

Crafted entirely from solid bluestone, the exterior showcases quality craftsmanship from the moment you

Price : Contact Agent
Land Size : 1405 sqm
View : <https://www.ous.property/sale/sa/north-north-east-suburbs/highbury/residential/house/7980962>



Desi Moutzouris
7225 9800



Laz Ouslinis
7225 9800

<https://www.ous.property>

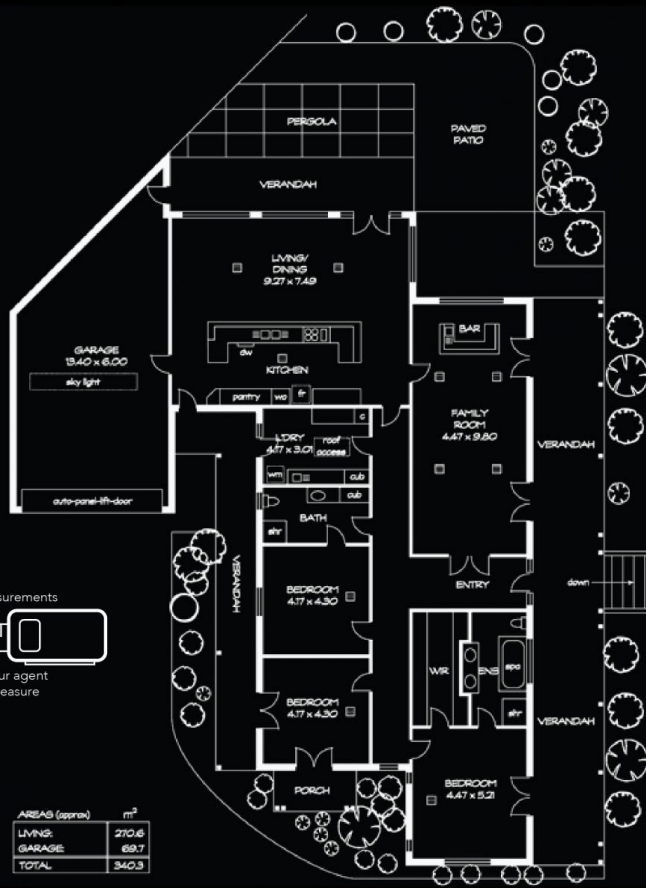

*To check measurements



Please ask your agent
for a tape measure

AREAS (approx)	m ²
LIVING:	270.6
GARAGE:	69.7
TOTAL:	340.3